

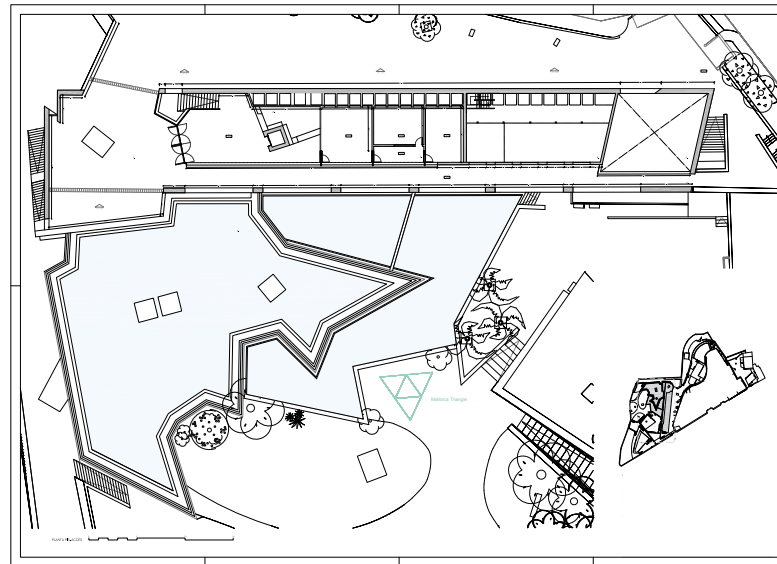

serdica triangles - moneo building area, pilar i joan miró a mallorca foundation, mallorca spain 2013 design: jan doms | realization: Jan Doms and Olga Doreva | visualisation: ir. philip van boxtel | principal: sant marc and joan miró a mallorca foundation



the initial inspiration for the **serdica triangles** were the triangular fortifications that are part of the roman remains in sofia. in this case the triangles are adapted to the idiom of the architect of the miró museum, rafael moneo.



plan area and definitive position of triangles



preliminary design triangle in moneo buiding area



triangle in sculpture garden